



S-NET Connect Mobile V6

Download & Installation Guide



Download and Install S-NET Connect Mobile

1. Open iTunes on your iPhone and search for S-NET Connect. Select **GET**.
 2. Select **Install** and wait for the application to download and install.
- **Note:** If you already have S-NET Connect Mobile 5, you can skip ahead to step 9 after installation.

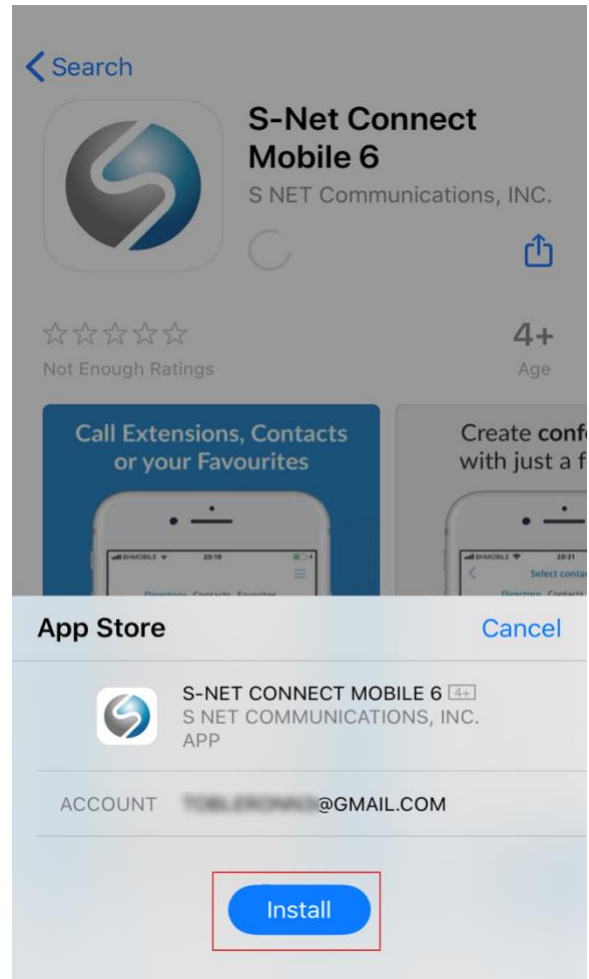
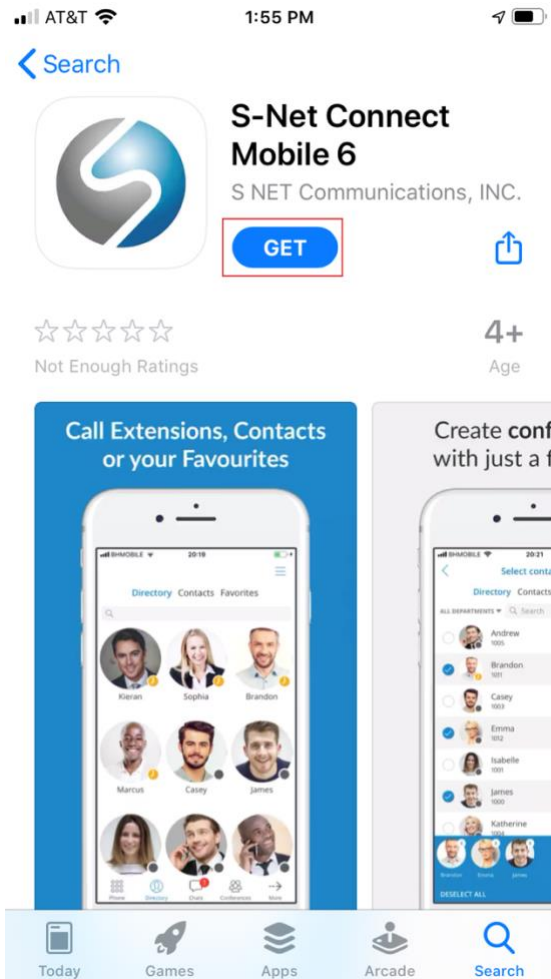

3. Click [Open](#) or navigate to your home screen to open the application.

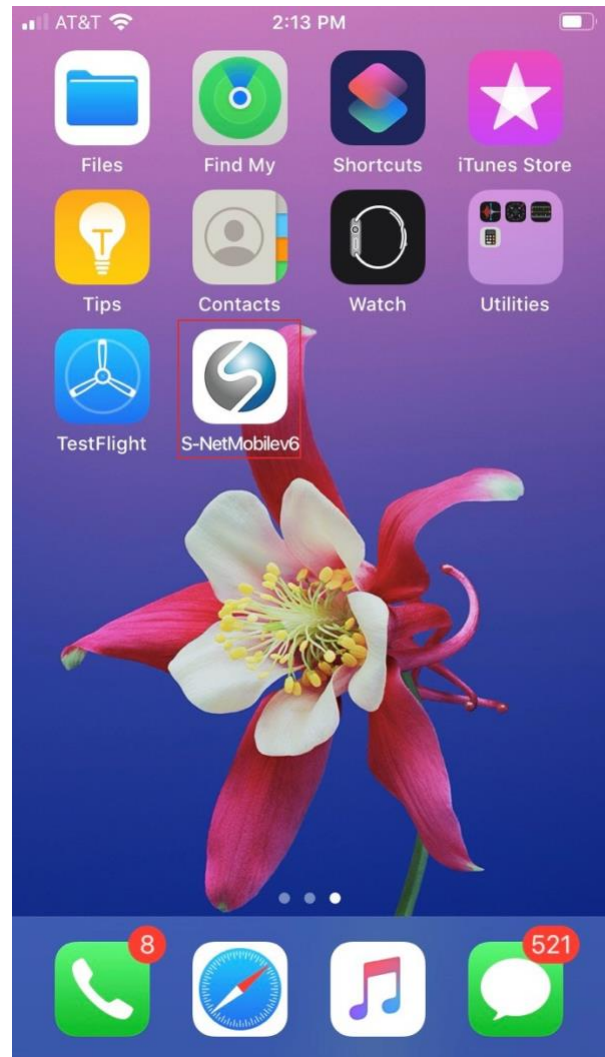
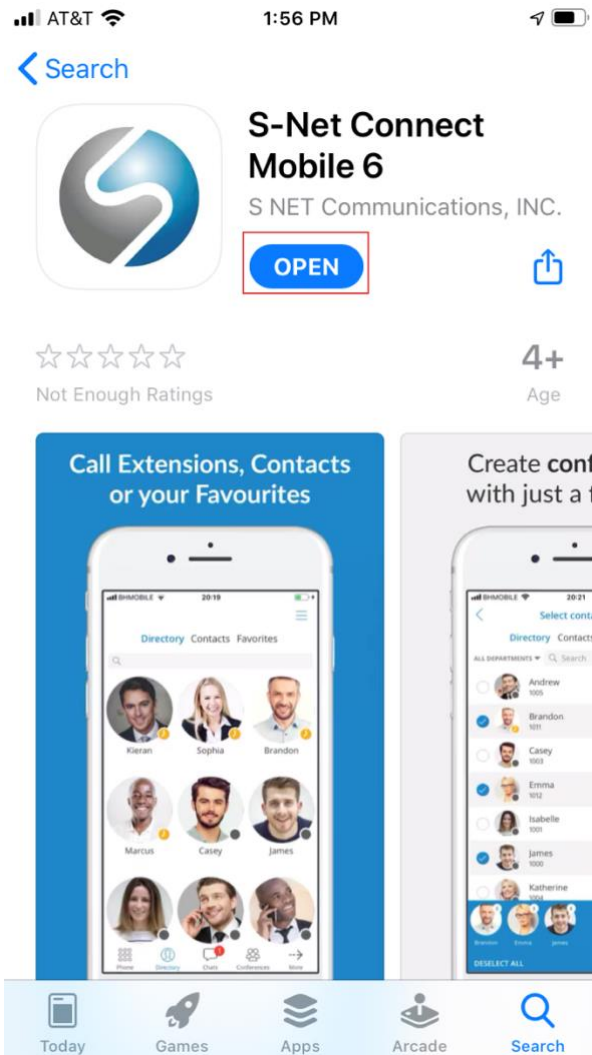

4. Enter your work email address, password and server information.

- i. **Username:** Your work email address
- ii. **Password:** Your S-NET Connect password
- iii. **Host:** Server URL provided by the S-NET Team

The S-NET Communications Team will provide you with a server URL, as well as a temporary password if you are a first-time user of S-NET Connect

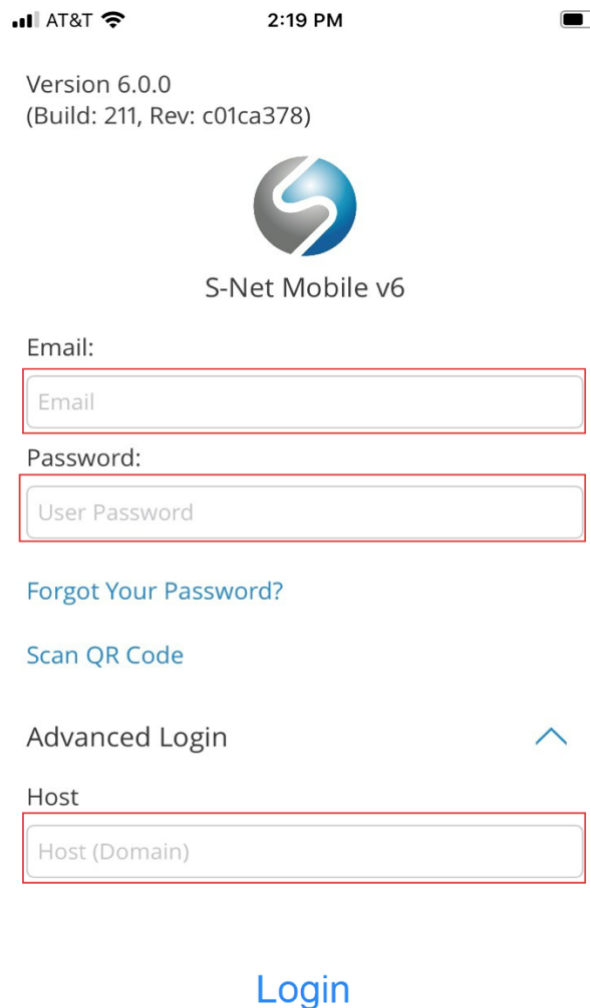

AT&T 2:19 PM

Version 6.0.0
(Build: 211, Rev: c01ca378)



S-Net Mobile v6

Email:

Password:

[Forgot Your Password?](#)

[Scan QR Code](#)

Advanced Login 

Host

[Login](#)

5. Press the [Log In](#) button at the bottom of the screen.

6. When prompted, create a new password for your S-NET Connect account. Your new password needs to include an upper- and lower-case character, a number and a special character.

➤ **Password requirements:**

- i. 1 uppercase character
- ii. 1 lower case character
- iii. 1 number
- iv. 1 symbol

7. After entering the password. Click [Done](#).

8. Then press [Allow](#) and [OK](#).

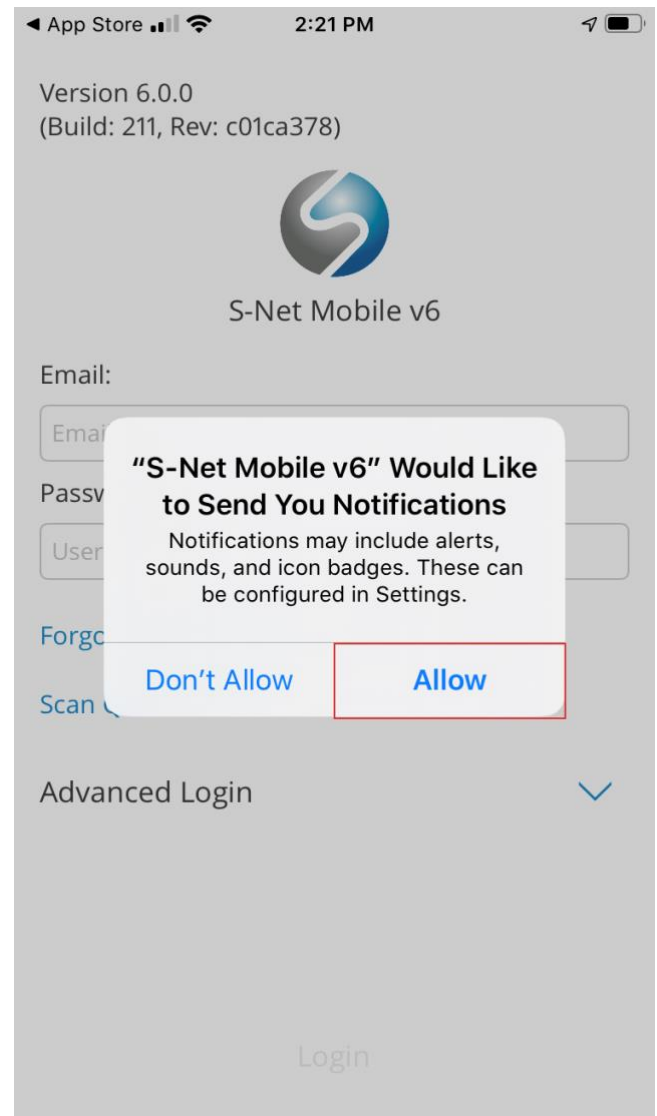
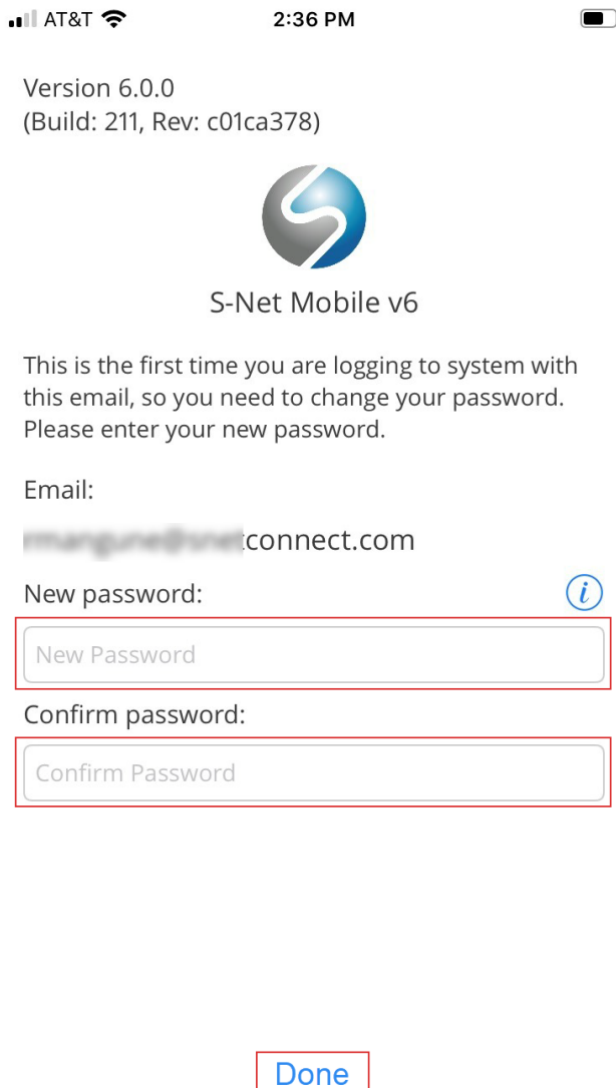

Delete S-NET Connect v5

9. Select and hold the S-NET Connect Mobile v5 icon and press Delete App.

